**1009 Center
Parkway
Kennewick WA**

Office Space for Lease
MLS #224380

KIRT SHAFFER
509.521.9183
kirt@tippettcompany.com

PRISCELY GUTIERREZ
509.591.5676
priscely@tippettcompany.com



1009 Center Parkway

Owner:	Metropolitan Investments
Tax Parcel No.:	131991000015006
Suite Number:	203
Parcel Size:	4.59 Acres
Year Built:	1998
Square Footage:	2,737.03 USF / 3,051.67 RSF
Zoning:	CO (Commercial Office)
Lease Price:	\$14.00/s.f. (\$3,560.28/mo.)
Lease Type:	NNN (\$7.00/s.f.)
Utilities:	Included in NNN's

Two-story, three tenant building. ConAgra occupies the first floor; New York Life occupies the remainder of the second floor. Building is located within the Central Business District of the Tri-Cities. Building is situated on a beautiful campus setting with gorgeous greenscapes and an abundance of parking. Building is located near a regional shopping mall, a plethora of restaurants, coffee shops and other services.

No warranty or representation, expressed or implied, is made as to the accuracy of information contained herein, and same is submitted subject to errors, omission, change of price, rental or other conditions and withdrawal without notice. Lessor and his/her agent are responsible for independently verifying all presented information.

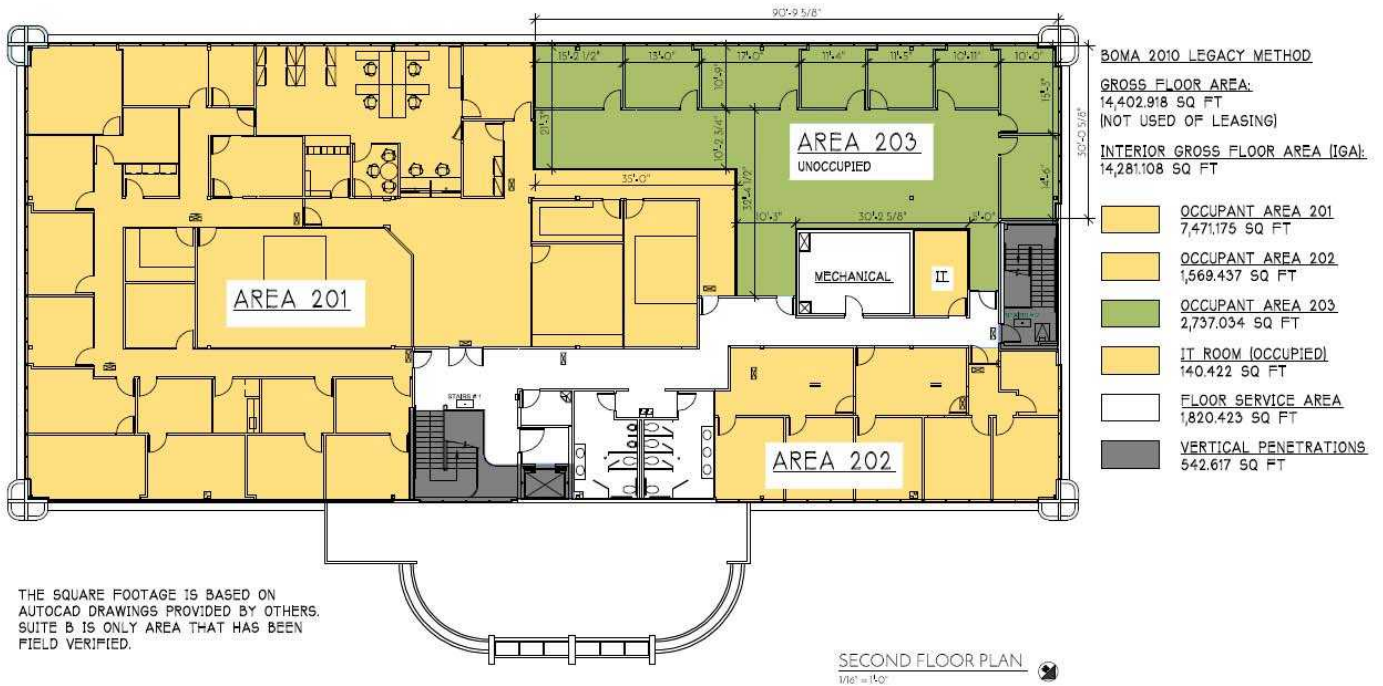
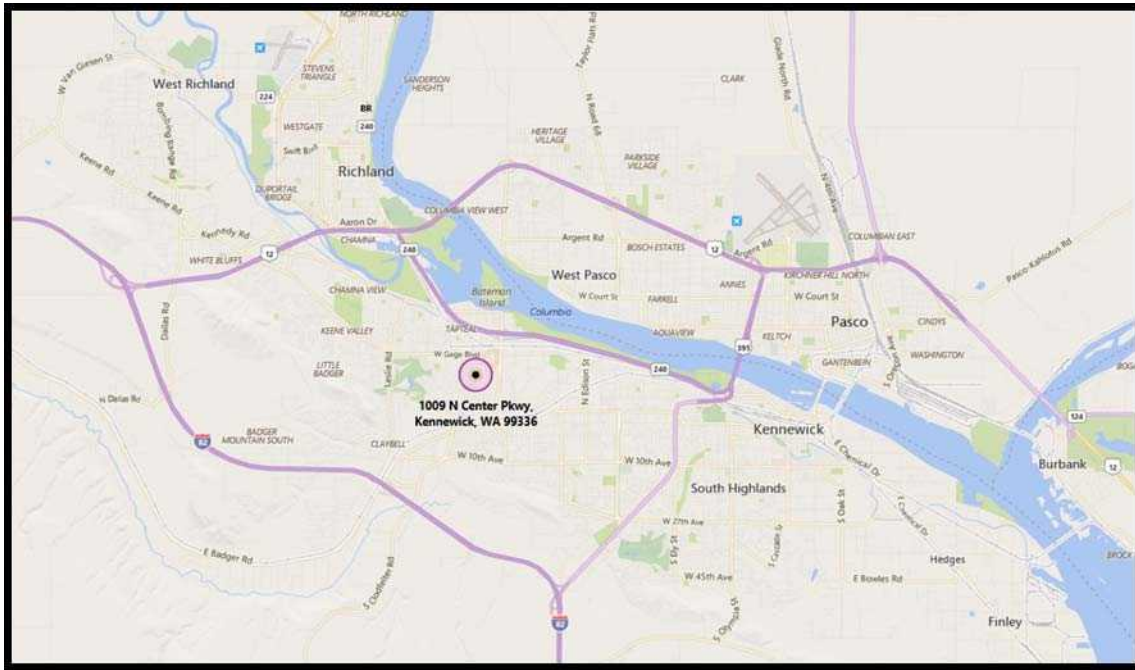

1009 N CENTER PARKWAY BUILDING - BOMA PLANS
1009 N CENTER PARKWAY KENNEWICK, WA

ARCHIBALD & C²
ARCHITECTS, P.S.

No warranty or representation, expressed or implied, is made as to the accuracy of information contained herein, and same is submitted subject to errors, omission, change of price, rental or other conditions and withdrawal without notice. Lessor and his/her agent are responsible for independently verifying all presented information.



No warranty or representation, expressed or implied, is made as to the accuracy of information contained herein, and same is submitted subject to errors, omission, change of price, rental or other conditions and withdrawal without notice. Lessor and his/her agent are responsible for independently verifying all presented information.



No warranty or representation, expressed or implied, is made as to the accuracy of information contained herein, and same is submitted subject to errors, omission, change of price, rental or other conditions and withdrawal without notice. Lessor and his/her agent are responsible for independently verifying all presented information.

CONTACT:

Tippett Company
2815 St. Andrews Loop, Suite F
Off: 509.545.3355
Fax: 509.545.1689
www.tippettcompany.com

Kirt Shaffer / Managing Broker
509.521.9183
kirt@tippettcompany.com

Priscely Gutierrez / Broker
509.591.5676
priscely@tippettcompany.com

No warranty or representation, expressed or implied, is made as to the accuracy of information contained herein, and same is submitted subject to errors, omission, change of price, rental or other conditions and withdrawal without notice. Lessor and his/her agent are responsible for independently verifying all presented information.